

# RS-KLM-PLT series

Installation Manual



+48 12 653 53 85/86

dok@sabaj.pl

ul. Domagały 15,  
30-841 Kraków

www.sabaj.pl

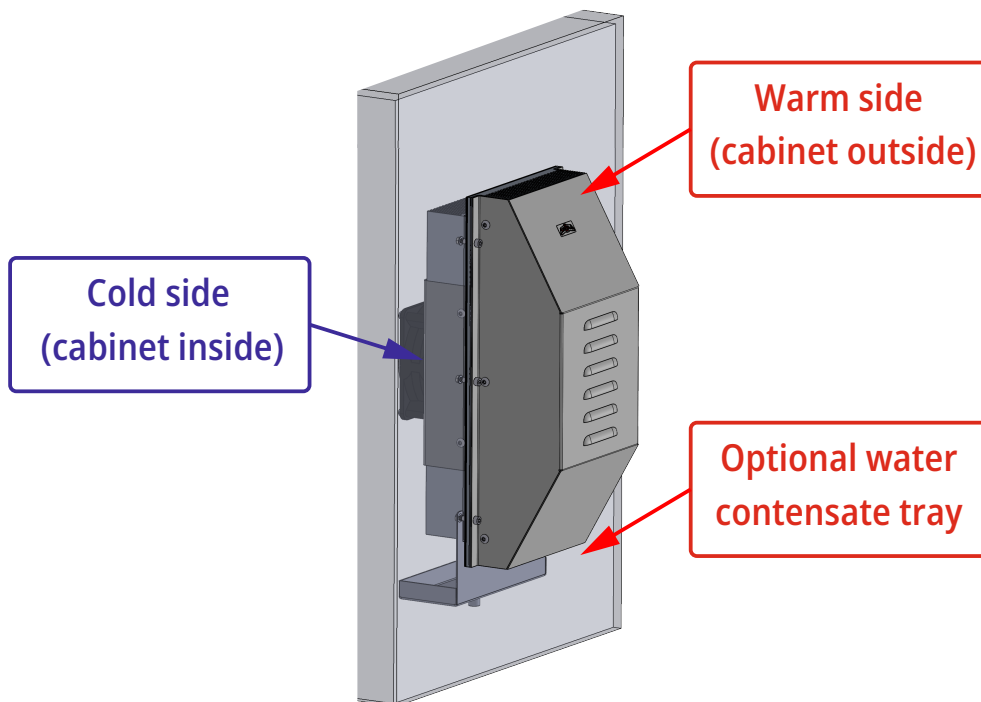

Make sure the cooling unit is placed properly inside the cabinet. Refer to the cutout drawings. Proper airflow is also crucial for cooling capacity. Make sure to leave enough free space for air to circulate

**RS-KLM-100 PLT**

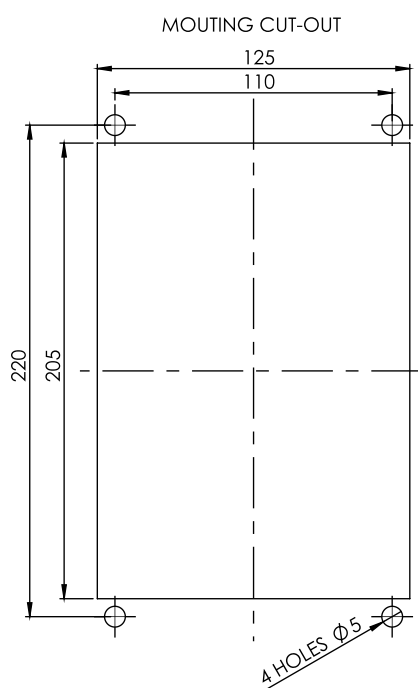

**RS-KLM-200 PLT**

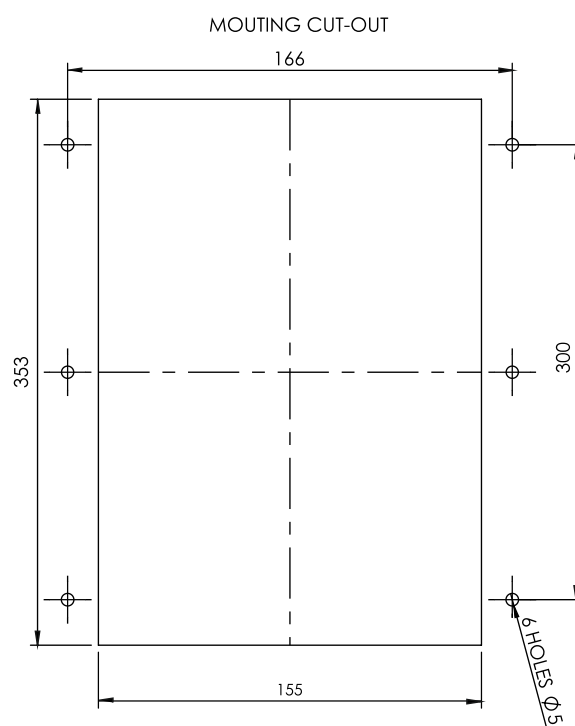

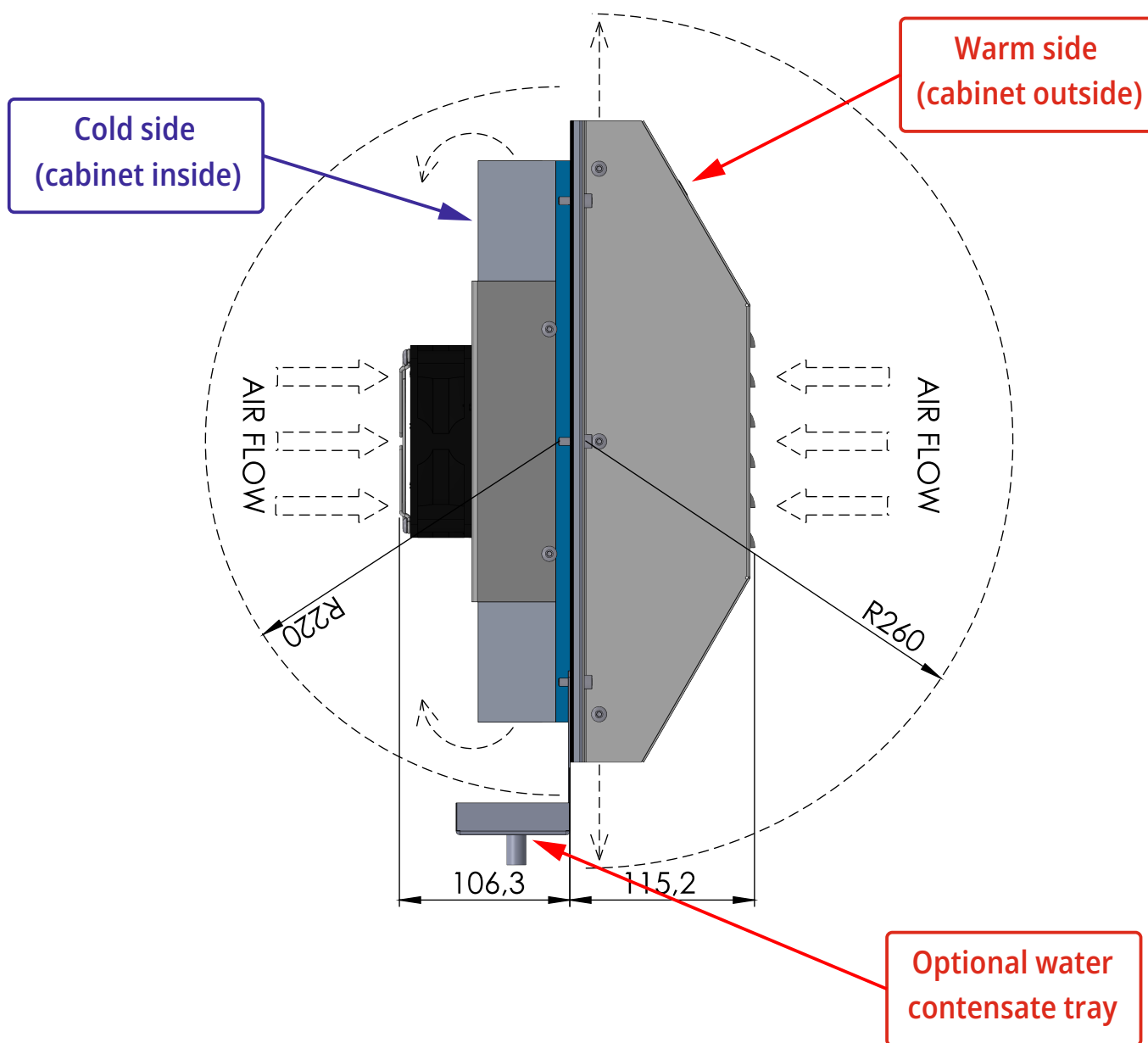

### WATER CONDENSATE

Under certain conditions, it is possible for water condensation to accumulate on the cold side of the radiator. To prevent water from dripping off the radiator, it is advisable to utilize either a condensate tray RS-KLM-RO-100 or RS-KLM-RO-200 depending on the type of air conditioner being used.

## ELECTRICAL CONNECTIONS

1. Although the unit operates in 24V DC, it can be powered by lower voltage systems. It will not carry the same cooling power in this regard.
2. The two cooling units (TEC 24V) and fans can be operated separately, but it is recommended to power everything in paralel, to achieve propper cooling power.

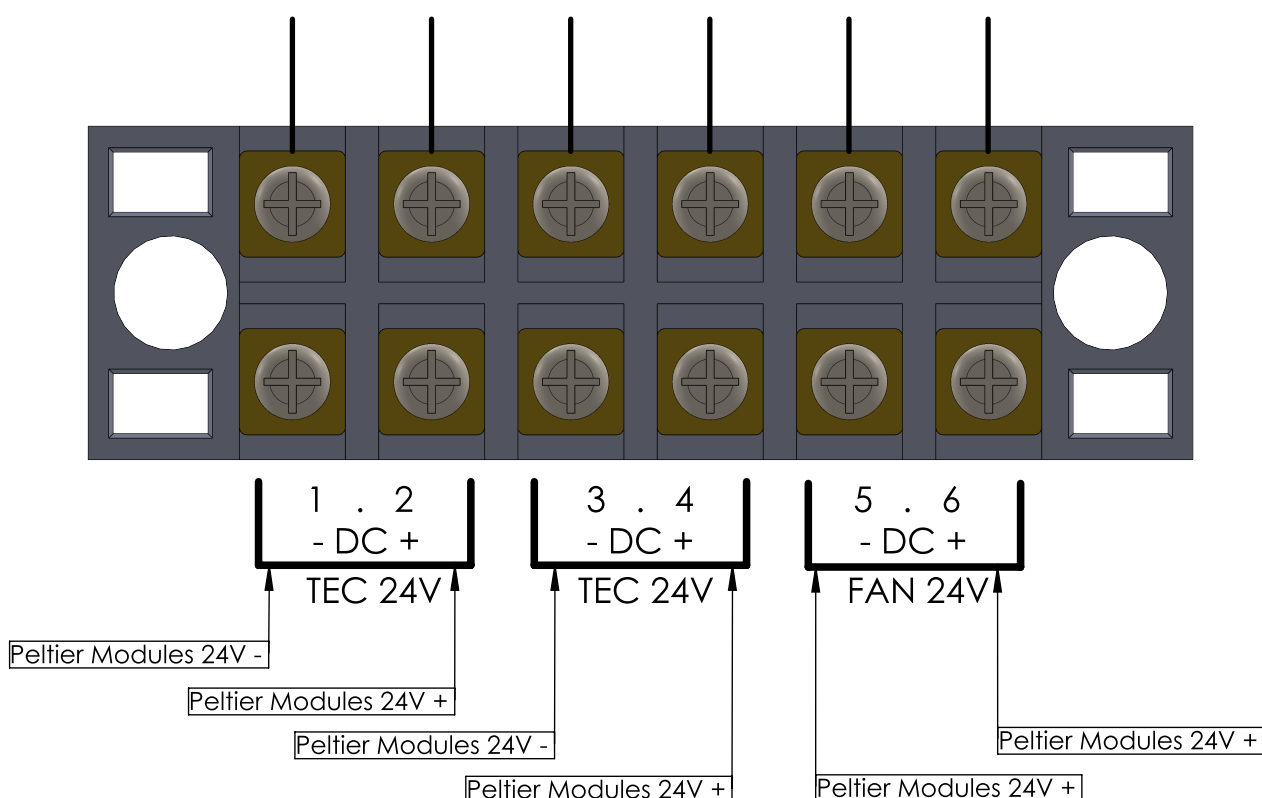

## POWER SUPPLY

For the whole unit to work correctly, you must pick a power supply that meets or exceeds max (start) current consumption , provided in tech sheet for a certain model.

### USAGE DISCLAIMERS:

- All the installation work should be done by a professional, following all directives and norms regarding electrical units.
- Make sure that TCU unit is not a subject to accidental damages or impacts. Keep in mind, that the thermoelectric units are made of very delicate ceramic plates, which are prone to mechanical damage. They could also be damaged with high temperature shocks, therefore pouring cold/hot water directly should be avoided.
- Required Voltage 24 V with less than 10% interference.
- Cells should not be soaked in water
- Keep the cooler at least 10 cm away from other equipmen during installation.
- Do not use in environments where the temperature may exceed 70 °C.